

6.

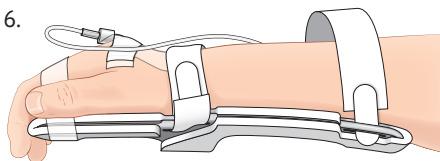

Wrap strap around forearm. Thread Velcro tab through slot at forearm. Pull the tab through the slot, fold the strap back around the outer edge of the splint onto itself, and secure it with the Velcro tab.

Note: Slip one finger beneath each strap to ensure the fabric is not so tight that it impedes circulation or infusion of IV fluids.

7.

Optional Strap Configuration

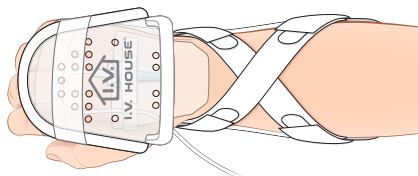

If the wrist strap obscures the catheter insertion site, consider a crisscross strap configuration instead.

Put the wrist strap through the forearm slot and the forearm strap through the wrist slot. This will allow easy visual inspection of the catheter insertion site.

Notes: Protect the catheter and loop of tubing with an I.V. House UltraDressing® or I.V. House UltraDome®.

Check IV site hourly for redness, swelling, and tenderness. **Touch, Look, and Compare** the IV site with the opposite palm and forearm. Change the TLC Wrist Splint each time a new IV is inserted.



Video Directions: www.ivhouse.com/how

Manufactured for I.V. House, Inc.
2072 Concourse Dr.
St. Louis, MO 63146 USA
IVinfo@ivhouse.com (E-mail)
www.ivhouse.com
800-530-0400 (Toll Free)
314-453-9200 (Phone)
314-453-9576 (Fax)

Patents Pending
All Rights Reserved
Made in USA



Wellkang Enterprise Hub,
NW Business Complex, 1 Beraghmore Rd,
Derry, BT48 8SE, Northern Ireland.



WRIST / TODDLER / 9-15 kg

TLC® Wrist Splint with Straps

Touch/Look/Compare

M

939M-W-Ultra

1 Medium (Toddler) Size Foam Padded Wrist Splint
with Two Straps and Velcro® Closure

Fits most toddlers ages 12-36 months,
or weighing 9-15 kg

CATALOG ITEM:

REF 939M-W-Ultra



LOT 2022-07-01-939M-W-Ultra REV 0722



I.V. HOUSE®
Protection Over and Above®

I.V. House 939S-Ultra or 939M-Ultra TLC® Wrist Splint Directions

Single Use Only—Fits either wrist. The TLC Wrist Splint can be applied to the wrist before or after inserting IV and connecting to extension set or IV tubing.

939S fits most infants 0–12 months, or weighing 2.5–12 kg. **939M** fits most toddlers 12–36 months, or weighing 9–15 kg.

1.

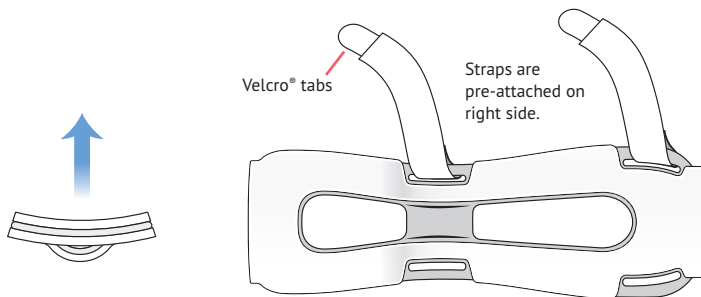

Unroll the TLC Wrist Splint straps and identify the smooth concave surface of the splint. This concave surface will be placed against the patient's hand and forearm.

2.

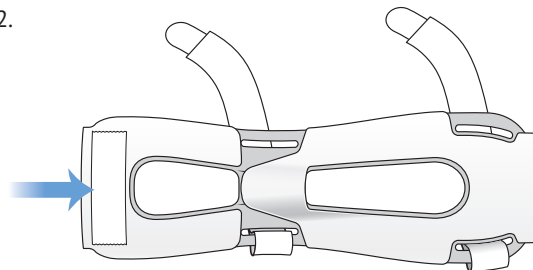

Turn the splint over and apply a strip of tape to the foam on the back of the splint, near the end with no strap.

This is an anchor tape strip to which all other tape will be applied.

3.

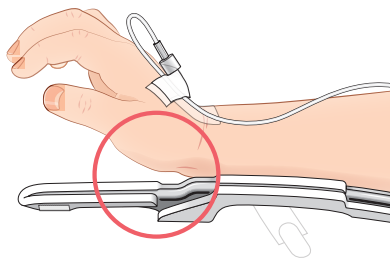

Place the splint under the patient's forearm, with the heel of the hand landing in the slight bend in the device. This places the hand in a functional position.

4.

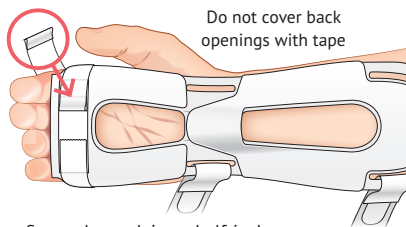

Secure fingers by applying a half-inch strip of tape to the anchor strip placed earlier.

Wrap tape around fingers and back onto the anchor tape on the bottom. Fold under one end to create a tab for easy removal.

5.

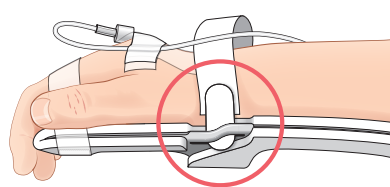

Wrap strap around wrist. Thread Velcro® tab through slot in the splint at patient's wrist.

Pull the tab through the slot, fold the strap back around the outer edge of the splint onto itself, and secure it with the Velcro tab.

Directions continued on back